

REMOVE AND REPLACE PCC/AC PAVEMENT TO LIMITS OF SAWCUT LINES IN ACCORDANCE WITH LBWD STD. DWG. WDS-406 AND JURISDICTIONAL AGENCY PERMIT REQUIREMENTS

REMOVE EXISTING CAST IRON VALVE BOX AND LID

SAWCUT (TYP)

EXISTING AC PAVEMENT

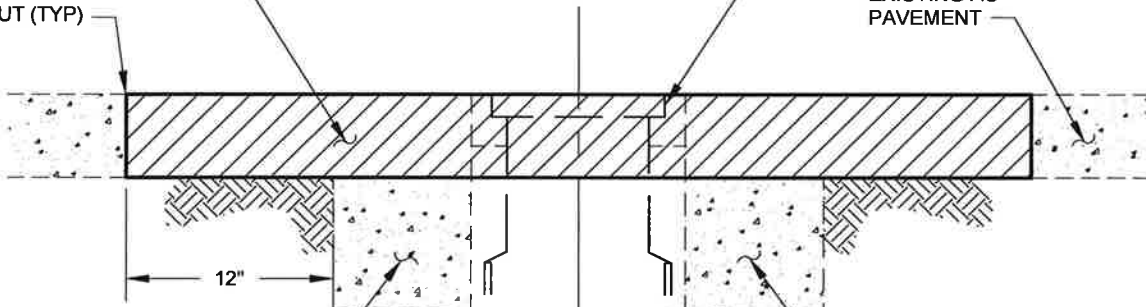

FILL WITH 1-1/2 SACK CEMENT SLURRY TO POINT WHERE PAVEMENT BEGINS

REMOVE EXISTING CONCRETE COLLAR

COMPLETELY REMOVE EXISTING RISER PIPE

LBWD STAFF TO CLOSE EXISTING VALVE BEFORE BACKFILLING. CONTRACTOR TO COORDINATE WORK EFFORTS WITH LBWD.

**NOTES :**

1. REMOVE VALVE BOX AND COVER, SALVAGE, AND DELIVER TO LBWD.

**VALVE ABANDONMENT**

**WDS - 127**



**LONG BEACH  
WATER DEPARTMENT**

RECOMMEND

*Robert J. [Signature]*  
DIVISION ENGINEER

APPROVED

*[Signature]*  
DIRECTOR OF ENGINEERING

DATE: 10/13/14

SCALE: N.T.S.

SHEET 1 OF 1