

CONCRETE SHELF RETROFIT
PLAN VIEW (N.T.S)

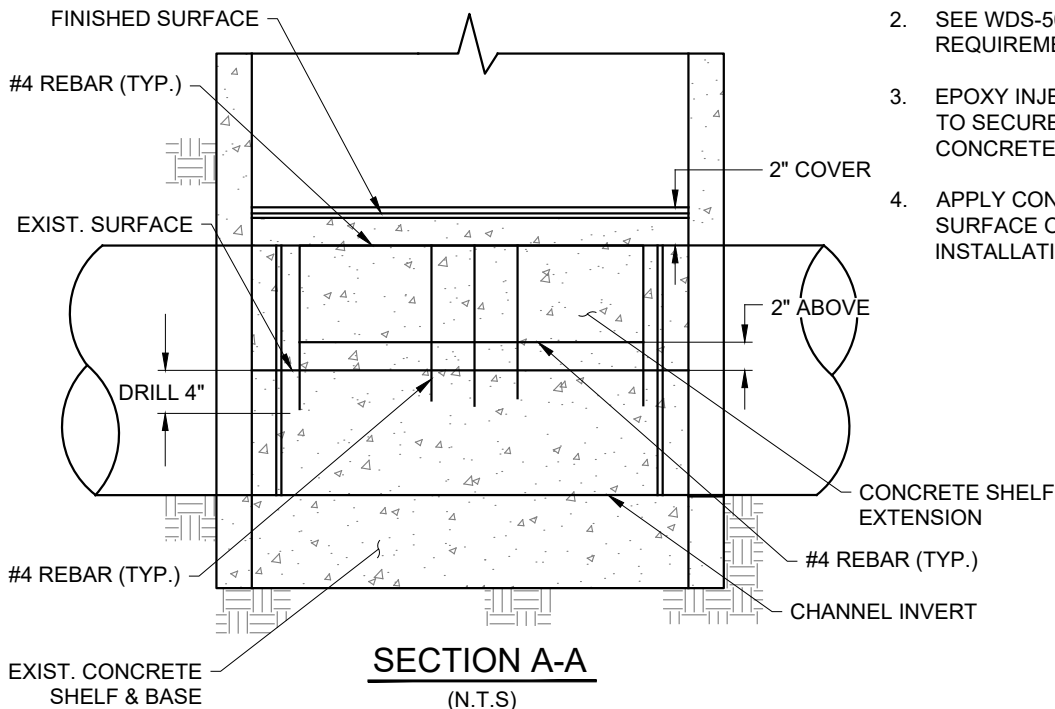

NOTES:

1. CONCRETE SHELF SHALL BE A 4000 PSI, HIGH-EARLY-STRENGTH, POLAR MIX WITH 3/4" MAX AGGREGATE. CONTRACTOR SHALL SUBMIT MIX DESIGN TO LBWD PRIOR TO POUR.
2. SEE WDS-502, DETAIL A, FOR SHELF SLOPE REQUIREMENTS.
3. EPOXY INJECTION GROUT SHALL BE USED TO SECURE #4 REBAR INTO EXISTING CONCRETE SHELF.
4. APPLY CONCRETE BONDING AGENT TO SURFACE OF EXISTING SHELF PRIOR TO INSTALLATION OF NEW CONCRETE SHELF.



SECTION A-A
(N.T.S)

CONCRETE SHELF RETROFIT

WDS - 512



Long Beach Water
Exceptional Water • Exceptional Service

RECOMMENDED

Robert Johnson

DIRECTOR OF ENGINEERING

APPROVED

Debra Paul

DEPUTY GENERAL MANAGER / CHIEF ENGINEER

DATE: 02-2020

SCALE: N.T.S.

SHEET 1 OF 1